



MOON WALK

INTEGRATED SOLAR LED LIGHT

Solar Panel + Lithium Battery + LED Light+ Controller + Bracket



Patent product **CE** **RoHS** **FC** **cec** IP65

MENGAPA MEMILIH MOON WALK?

- Dilengkapi Remote control dengan mode operasi yang sederhana. Dapat mengganti ke berbagai mode dengan sangat mudah.
- Aplikasi Wireless, Panel Surya, Lampu LED, Baterai Lithium, Mikro Kontroller, Bracket, dan asesoris lainnya terintegrasi dalam satu system yang *simple* dan *stylish*.
- Dikontrol oleh Micro-controller dan menggunakan Sensor gerakan untuk pengontrolan cahaya dan waktu operasi.
- Sangat mudah dalam pemasangan, Tidak membutuhkan listrik dari luar, tidak membutuhkkn kabel, hanya dalam 2 menit lampu sudah selesai terpasang.
- Panel surya dapat diatur kemiringannya baik secara vertical/horizontal untuk mendapatkan sudut penyinaran yang maksimum dari matahari.
- Menggunakan baterai Lithium menggantikan Baterai Gel/Lead Acid sehingga memiliki lifetime yang lebih panjang
- Waktu menyala panjang, dapat beroperasi continu 2-3 hari dalam kondisi hari mendung/hujan (kurang cahaya matahari)
- Harga kompetitif dan transportasi akan sangat mudah dibandingkan dengan system lampu jalan modular (yang terpisah antara baterai, panel surya, dan lampu).
- IP 65 sehingga aman untuk ditempatkan di area terbuka

Details:

Monocrystalline



- 18% photoelectric conversion efficiency
- Tempered glass cover
- 20-25 years lifetime

High lumen led chip



- 45mil led chip, 160lm/w
- ≥ 50000 hrs lifetime
- ≥ 75 Ra CRI

Smart Controller



- unique design
- 6 control modes, light control, motion sensor control, time control, motion sensor and time control, demo mode, off mode.
- Smart control, saving more and system works stably

Lithium ironphosphate battery



- High capacity
- No pollution and stable
- Long lifetime, ≥ 5000 times charge & discharge
- High temperature resistance

High quality body



- patented design
- Aluminum alloy, solid and firm
- Zinc plated, anti-rust corrosion
- Variety of installation methods

"Moon" shape cover



- 95% high light transmittance
- Strip cover, soft lighting for eyes
- High quality PMMA, long lifetime



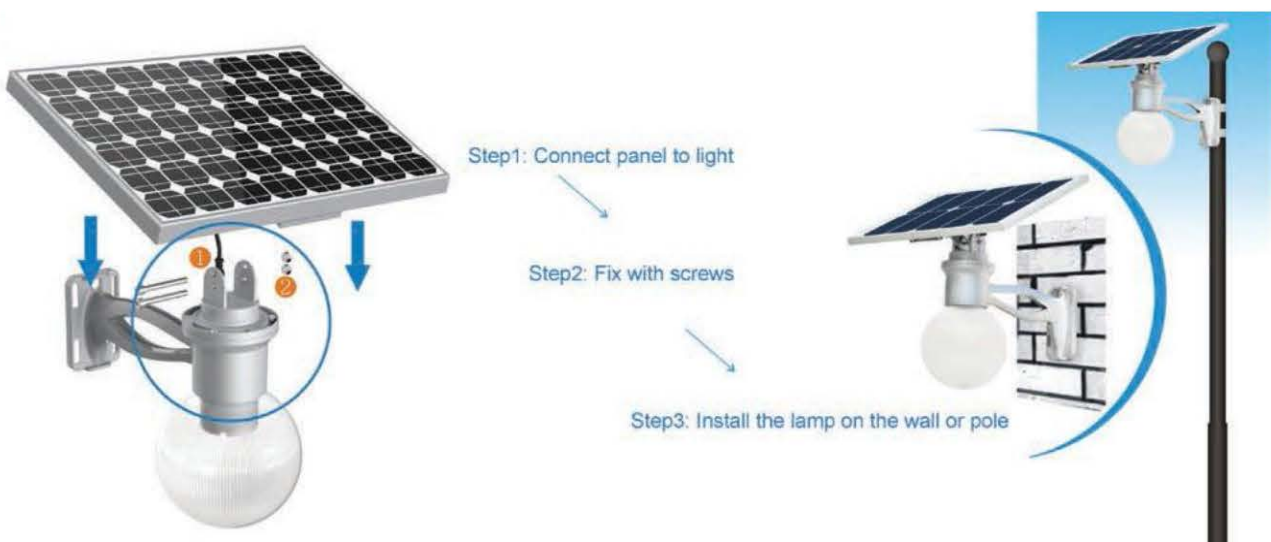

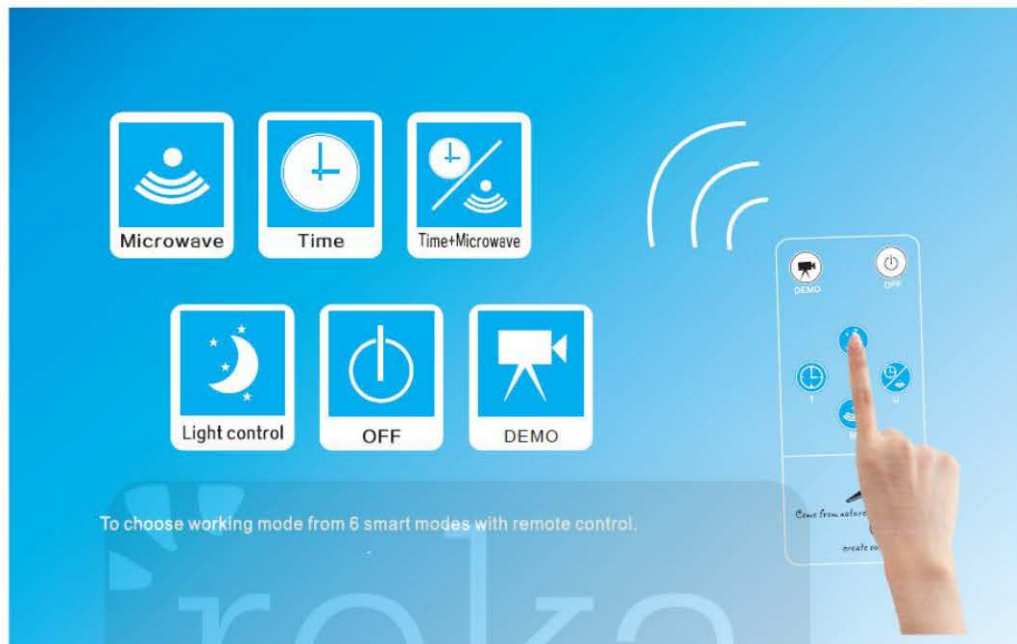

Instalasi sangat mudah dalam 2 menit!!



■ Remote Control



■ Six working mode choices

-  **DEMO:** No matter day or night, light "on" when people close, light "off" after people left. Only for test use.
-  **OFF:** Light "off", no matter day or night.
-  **L:** At night, 100% light when people close, 30% light after people left. In daytime, light "off".
-  **M:** At night, light "on" when people close, light "off" after people left. In daytime, light "off".
-  **T:** At night, 80% light for 2hours, 60% light for another 2hours, then light "off".
-  **U:** At night, 80% light for 2hours, 60% light for another 2hours, then turn to motion sensor, light "on" when people close, light "off" after people left.

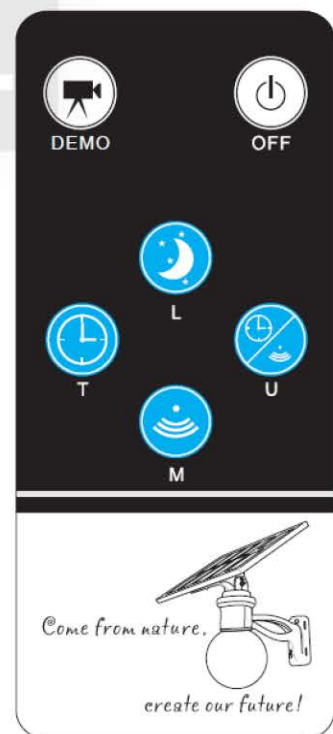

APLIKASI MOON WALK

- Taman	- Sekolah	- Jalan Pedesaan
- Rumah/Villa	- Area umum	- Halaman Kantor/Gedung
- Pertanian	- Pedestrian	- dll



Parameters:

Type	RL-MW-R12	RL-MW-R25	RL-MW-R40
Lamp power	4W	8W	12W
Solar panel	12W/5V	25W/5V	40W/13.5V
Lithium battery	10AH/3.2V	20AH/3.2V	10AH/9.6V
LED qty	6pcs	6pcs	12pcs
Luminous flux	600-720lm	1200-1440lm	1500-1800lm
LED chip	Bridgelux		
Color temperature	3000-6500K		
CRI	≥75Ra		
Light control voltage	1V		
Illumination (stand by)	30%		
Sensor area	<10meters		
Lighting last	20s		
Charge time	6hours		
Discharge time	24hours		
Working temperature	-20-60°C		
Lifetime	≥50000hours		
Material	High quality aluminum alloy, die-cast aluminum		
Mounting height	3-6meters		
Installation spacing	8-10meters		

The data of its working time was measured at latitude 22 °, 113 ° east longitude in sunny days.
The working time will be affected by the surroundings.